

BRS-4 UL2, T.E.A.M. MINI-MAX

Pull up all slack and stow excess under turtle deck.

7-88

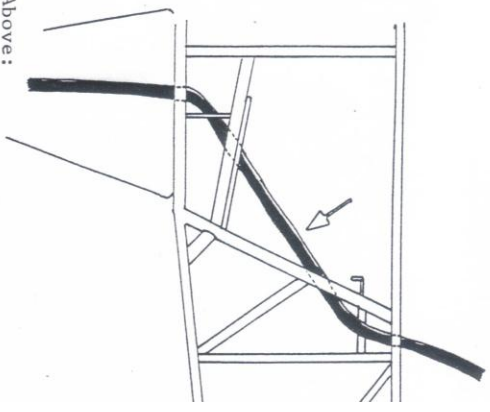
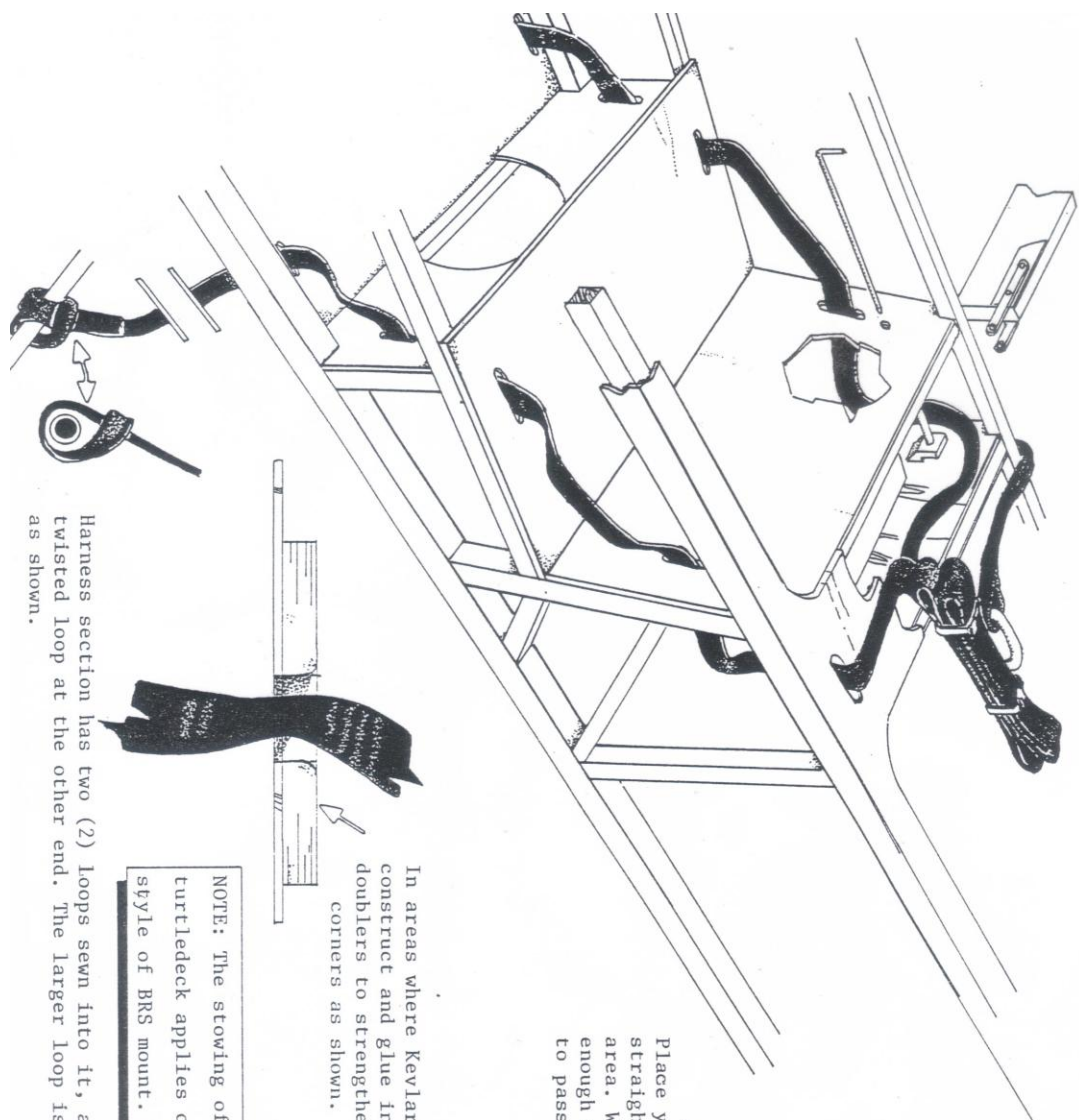

Above:
Place your holes so kevlar passes as straight as possible through cockpit area. When making holes, remove only enough material to allow harness section to pass through.

In areas where Kevlar passes through thin plywood construct and glue in place 1/2 to 5/8" plywood doublers to strengthen hole. Radius the inside corners as shown.

NOTE: The stowing of the Harness system under the turtledeck applies only to the external canister style of BRS mount. Internal mount users disregard.

Harness section has two (2) loops sewn into it, a small loop and a larger twisted loop at the other end. The larger loop is used to wrap around the axle as shown.